

ATX 130

BLDG. 2

| | |
|----------------------------|-----------|
| BUILDING SIZE: | 80,365 SF |
| MINIMUM DIVISIBLE: | 16,640 SF |
| SPEC OFFICE: | 3,511 SF |
| BUILDING CONFIG: | Rear Load |
| BUILDING DEPTH: | 160' |
| DOCK DOORS: | 28 |
| DRIVE-IN DOORS: | 2 |
| TRUCK COURT: | 130' |
| FIRE PROTECTION: | ESFR |
| MIN. CLEAR HEIGHT: | 28' |
| TYPICAL BAY: | 52' x 50' |
| SPEED BAY: | 60' |
| PARKING SPACES (APPROX.): | 139 |
| TRAILER PARKING (APPROX.): | N/A |



SPEC OFFICE

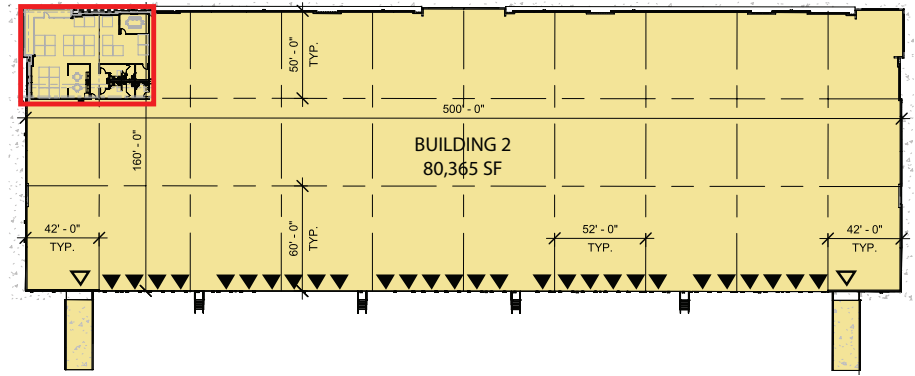

Total SF: ±3,511

