

ATX 130

BLDG. 1

BUILDING SIZE:	120,440 SF
MINIMUM DIVISIBLE:	21,840 SF
SPEC OFFICE:	3,332 SF
BUILDING CONFIG:	Rear Load
BUILDING DEPTH:	210'
DOCK DOORS:	31
DRIVE-IN DOORS:	2
TRUCK COURT:	185'
FIRE PROTECTION:	ESFR
MIN. CLEAR HEIGHT:	32'
TYPICAL BAY:	52' x 50'
SPEED BAY:	60'
PARKING SPACES (APPROX.):	Up to 348
TRAILER PARKING (APPROX.):	35



SPEC OFFICE

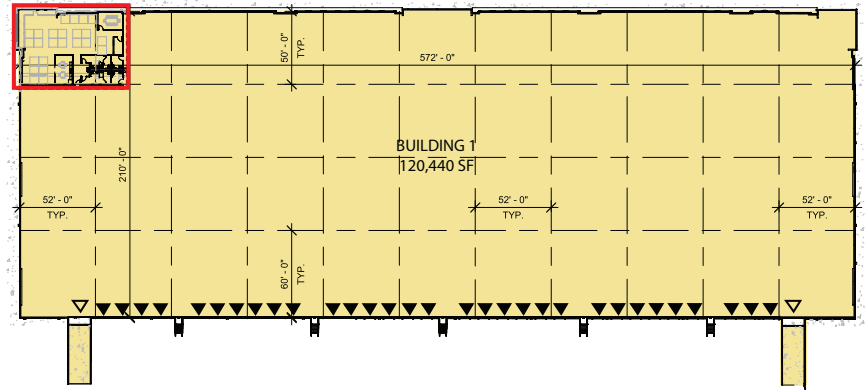

Total SF: ±3,332

