

SPEC OFFICE

TOLL ROAD 130/45

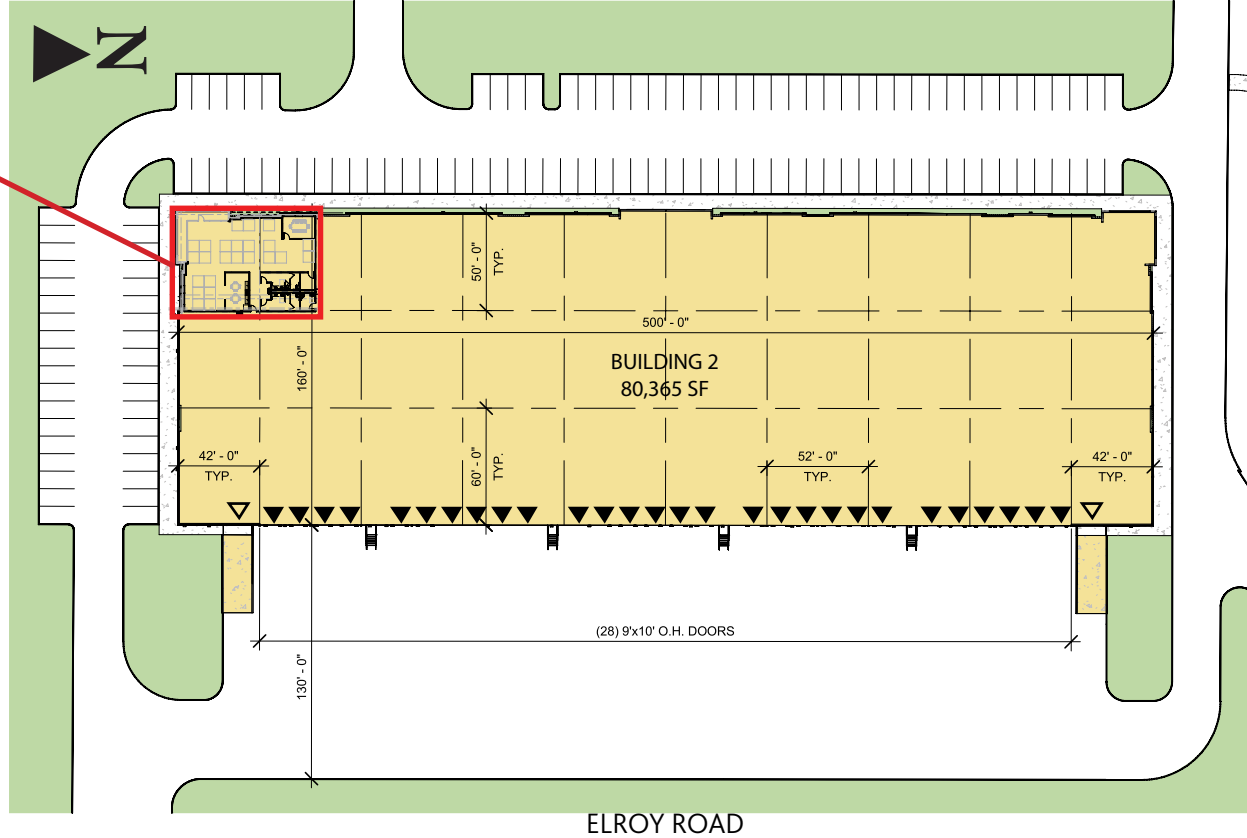

ELROY ROAD

ATX 130

BLDG. 2

BUILDING SIZE:	80,365 SF
MINIMUM DIVISIBLE:	16,640 SF
SPEC OFFICE:	3,511 SF
BUILDING CONFIG:	Rear Load
BUILDING DEPTH:	160'
DOCK DOORS:	28
DRIVE-IN DOORS:	2
TRUCK COURT:	130'
FIRE PROTECTION:	ESFR
MIN. CLEAR HEIGHT:	28'
TYPICAL BAY:	52' x 50'
SPEED BAY:	60'
PARKING SPACES (APPROX.):	139
TRAILER PARKING (APPROX.):	N/A



SPEC OFFICE

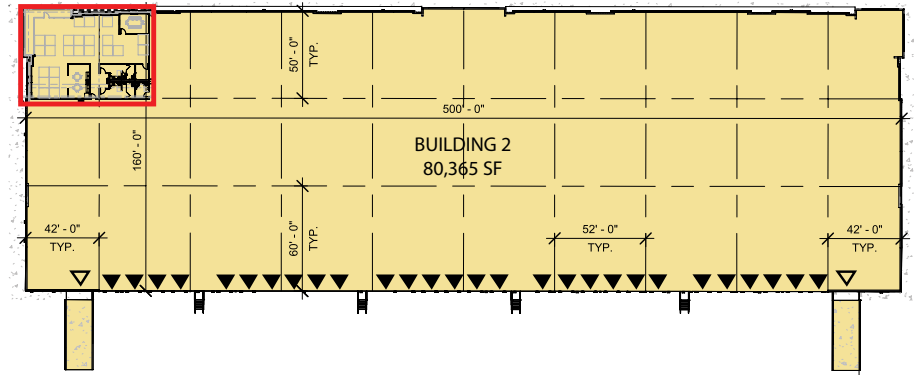

Total SF: \pm 3,511

