

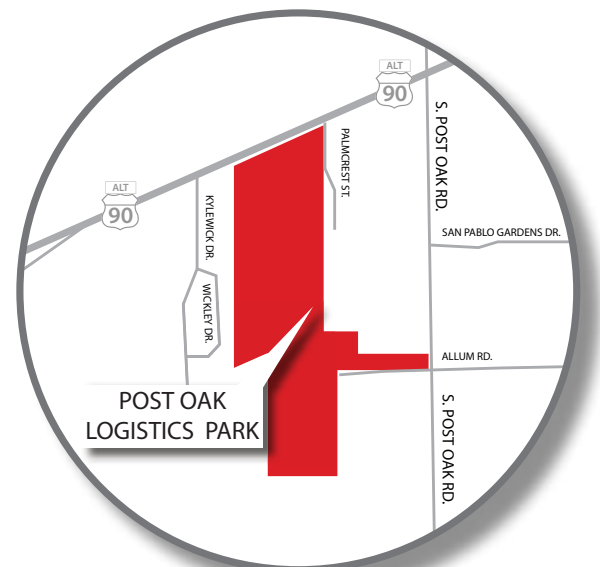

## POST OAK LOGISTICS PARK

**BUILDING B** 12631 MAIN STREET | HOUSTON, TX

<b>BUILDING SIZE:</b>	368,099 SF	<b>TRUCK COURT:</b>	130' & 185'
<b>MINIMUM DIVISIBLE:</b>	81,840 SF	<b>FIRE PROTECTION:</b>	ESFR
<b>BUILDING CONFIG:</b>	Cross Dock	<b>MIN. CLEAR HEIGHT:</b>	36'
<b>BUILDING DIMEN.:</b>	988' x 360'	<b>TYPICAL BAY:</b>	60' x 56'
<b>DOCK DOORS:</b>	102	<b>PARKING SPACES (APPROX.):</b>	246 + 124 Future
<b>DRIVE-IN DOORS:</b>	4	<b>TRAILER PARKING (APPROX.):</b>	58



# POST OAK LOGISTICS PARK

Building B | Up to 368,099 SF | Class A Core Industrial

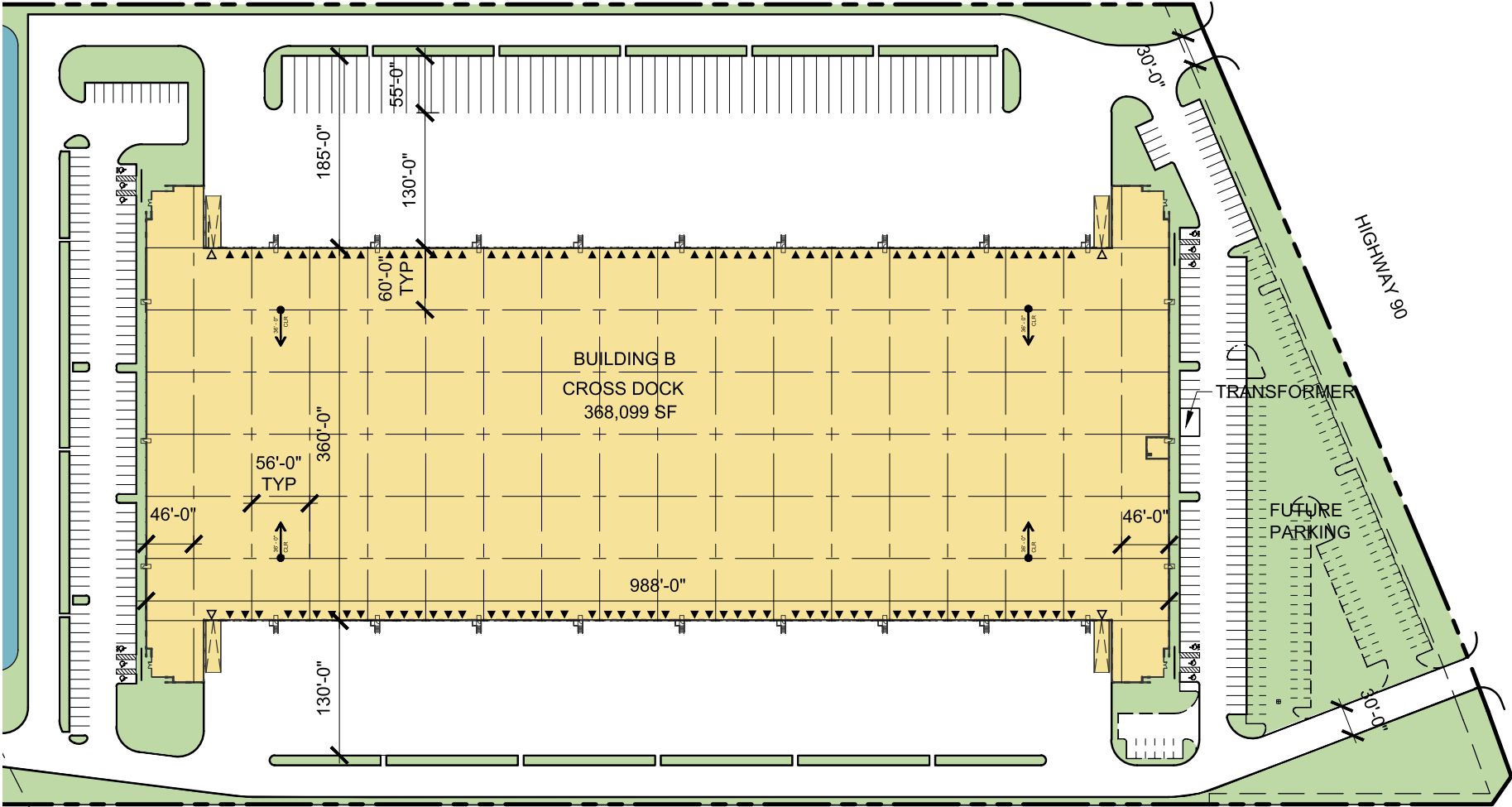

FOR LEASING INFORMATION



BEAU KALEEL, SIOR  
beau.kaleel@cushwake.com  
713.963.2844

MICHAEL FOREMAN  
michael.foreman@cushwake.com  
713.963.2850